



**KAVALIER**

# DECLARATION OF COMPLIANCE

Issuer's name/ producer: **KAVALIERGLASS, a.s.**  
 Issuer's address/Producer: **Křížová 1018/6, Prague 5**  
**office: Sklářská 359, 285 06 Sázava, Czech Republic**

Object of the declaration: **WATCH GLASS**

Catalogue Nr.	Product IDN	Marking	t [mm]	d [mm]	Radius ≈ R
170	00002P13800-10016	40	1,8	40	58
	00002P13800-10017	50	1,8	50	58
	00002P13800-10018	60	1,8	60	58
	00002P13800-10019	70	1,8	70	65
	00002P13800-10020	80	1,8	80	74
	00002P13800-10021	90	1,8	90	90
	00002P13800-10022	100	1,8	100	102
	00002P13800-10023	110	1,8	110	113
	00002P13800-10024	120	1,8	120	130
	00002P13800-10025	125	1,8	125	130
	00002P13800-10026	140	1,8	140	150
	00002P13800-10027	150	1,8	150	160
	00002P13800-10128	160	1,8	160	175
	00002P13800-10028	175	1,8	175	180
	00002P13800-10029	200	3,0	200	260
	00002P13800-10030	250	3,0	250	250
	00002P13800-10031	300	3,0	300	280

Scheme of the glass item

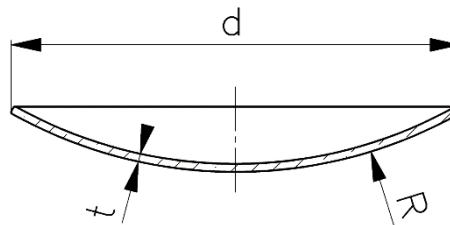

Material specification:		
Watch glass	clear	Soda-lime glass
Purpose of use	Used in chemistry as a liquid evaporation area for solids during weighing as a cover for a beaker and flask to minimize evaporation losses.	

**The object of the certificate described above is in conformity with the requirements of the following standards and regulations:**

**Glass characteristics:**

- **Commission Regulation (EU) No. 2023/2006** of 22 December 2006 on good manufacturing practice for materials and articles intended to come into contact with food
- **Regulation EC No 1935/2004 of 27 October 2004** on materials and articles intended to come into contact with food and repealing Directives 80/590/EEC and 89/109/EEC
- **Regulation of Czech Health Ministry Decree No. 38/2001, of the Coll. of Laws**, on hygienic demands for products intended to come into contact with food

**No heavy metals (lead, cadmium, mercury and hexavalent chromium):**

- Regulation (EC) No. 987/2008 of 8 October 2008 amending Regulation (EC) No. 1907/2006 – REACH as regards Annexes IV and V – glass was exempted from the obligation to register.
- **Chemical and physical characteristics of soda-lime glass** (approximate values)

Component	Content (percentage by weight)
SiO <sub>2</sub>	72,2%
Na <sub>2</sub> O	15,00 %
CaO	6,70 %
MgO	4,00 %
Al <sub>2</sub> O <sub>3</sub>	1,90 %
impurities	0,20 %

<b>Hydrolytic resistance</b>	HGB3 to ISO 719; HGA2 to ISO 720
<b>Coefficient of mean linear thermal expansion <math>\alpha</math>:</b>	$(8,7 \pm 0,3) \times 10^{-6} \text{ K}^{-1}; (20/300 \text{ } ^\circ\text{C})$
<b>Pharmaceutical use <i>European Pharmacopoeia (EP)</i></b>	Eur. Ph. 9.8 – 3.2.1
<b>Thermal shock resistance of sudden temperature changes</b>	$\Delta T = 90 \text{ } ^\circ\text{C}$
<b>Elastic modulus E</b>	72 GPa
<b>Density <math>\rho</math></b>	$(2,5 \pm 0,02) \text{ g/ cm}^3$
<b>Vickers hardness HV</b>	5,6 GPa
<b>Poisson's Coefficient</b>	0.22

Additional information:

The producer confirms hereby that the characteristics, measures and accuracy of the products listed above are in full conformity with the provisions of the standard.

The producer also declares that the products are safe when used in usual and proper way.

The producer has installed the Quality Assurance System according to ISO 9001 and thus guarantees that all products delivered to the market are in full conformity with the technical documentation and with all fundamental requirements to such products.  
Certificate No. 04 100 940602 issued by TÜV CERT, Certification Body at TÜV NORD CERT GmbH.

The certificate is issued for the customer: -

Sázava, 26. 07. 2021  
Place and date of issue

Ing. Kristýna Machová  
Project Quality Engineer

**KAVALIERGLASS, a.s.**  
Křižová 1018/6, 150 00 Praha 5  
office: Sklářská 359, 285 06 Sázava  
Czech Republic  
IČ: 474 68 815  
-61-